

TECHNICAL GUIDE



ELITE TRADE & CONTRACT
KITCHENS

Handleless Rail System



Date of
print/release

IMPORTANT PLEASE NOTE:

The information contained in this literature is for illustrative purposes only to assist in choosing your desired kitchen. While we endeavour to keep the information up to date and correct we do not make any representations or warranties of any kind, express or implied, about the completeness, accuracy, reliability and suitability of the doors and products that appear in this literature.

We aim to showcase as many different items as possible and therefore some products have been installed and photographed purely to show as many of our product features as possible and they should not be taken as an example of how they are intended to be installed in real kitchen installations.

It is therefore the responsibility of the installer to check the corresponding manufacturer's installation information and the manufacturer's technical information to ensure this is up to date and to ensure that the products can be fitted in a way they are displayed and the products are suitable for your requirements.

We specifically exclude any liability in this regard unless the products are fitted in accordance with the specifications we supply and the manufacturer's installation recommendations are used in a way recommended by the manufacturer and in accordance with the manufacturer's technical information provided.

The information shown in this literature is accurate as at the date of print/release shown on such information but it may be subject to changes after such date. Please therefore ensure that you are viewing the most current product information available and check with us if you have any doubt about the suitability of the product or accuracy of the information shown.

We are proud that all our products that we sell are covered by a statutory warranty but this does not stop all our products naturally ageing overtime. As a result of this natural ageing process we are therefore unable to provide an identical colour finish to the existing products you have purchased from us with any products that we supply you from the same product line. In such event our liability will be limited to the purchase price paid for the product you are seeking to replace.

Due to the limitations on photographic reproduction, colours may differ slightly from the actual products shown. Please note that board matches listed with the doors are a suggestion only and better board matches may be available on the market. It is up to the individual to decide on its suitability.

Please Note: The information shown in this literature is accurate as at the date of print/release shown on such information but it may be subject to changes after such date. Please therefore ensure that you are viewing the most current product available and check with us if you have any doubt about the suitability of the product or accuracy of the information shown.

HANDLELESS RAIL SYSTEM



Product Information

Description

Handleless rail system

Finish / Material

Aluminium

Lengths

Top / Mid Profiles: 4100mm

Vertical Profiles: 4200mm

Wall Profile: 3900mm

"We're proud to introduce a true handleless system, offering the ultimate streamlined look for a statement designer kitchen."



Top Profile

PRODUCT RANGE OVERVIEW

Wall Unit Profile

100WALL3900

Used for wall cabinet doors



Top Profile

100TOP4100

Used for doors and top drawers

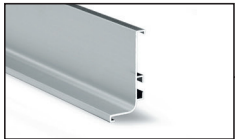

Mid Profile

100MID4100

Used for mid and bottom drawers



Vertical Profile - Intermediate

100VERTMID4200

Used between two tall units



Spacer for Appliance

100VERTSPACER

Used with Vertical Profile



External Corner Joint - Top

100TOPEXT90

Used to create a seamless design, combine with external corner post

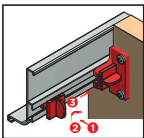

Quick Fix Brackets

100QFIX

Screw mounted



End Cap - Top

100TOPENDCAP

Used to finish top profiles



Vertical Profile - Lateral

100VERTEND4200

Used with one tall unit



End Cap - Mid

100MIDENDCAP

Used to finish mid profiles



Internal Corner Joint - Top

100TOPINT90

Combine with internal corner post



Joint Section - Top

100TOPJOINT

Used to join top profiles together



Internal Corner Joint - Mid

100MIDINT90

Combine with internal corner post

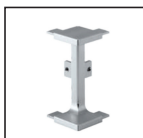

External Corner Joint - Mid

100MIDEXT90

Combine with external corner post

Top Profile

Code

100TOP4100

Finish / Material

Aluminium

Dimensions

4100 x 56.5 x 27.2mm

Accessories available

Quick Fix Brackets (100QFIX)

End Cap - Top (100TOPENDCAP)

Internal Corner Joint - Top (100TOPINT90)

External Corner Joint - Top (100TOPEXT90)

Joint Section (100TOPJOINT)



- Used for base unit doors and top drawers.
- Can be cut to size using a circular chop saw.
- Secured to cabinets with Quick Fix Brackets.
- Profiles can be finished off with End Caps before fitting.
- Top profiles can be linked at corners using Internal and External Corner Joints. A Joint Section can also be used to link together straight lengths.

DIMENSIONS

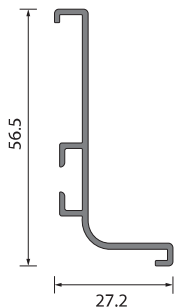

FITTED DETAIL

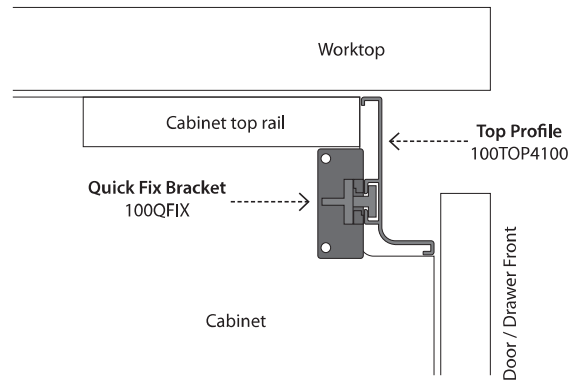

CABINET ROUTING

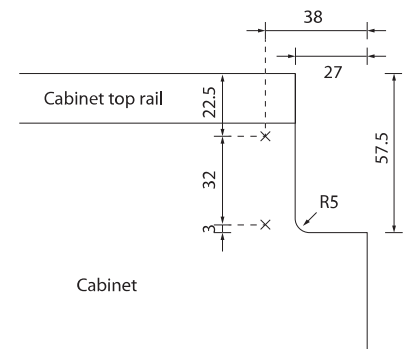

CABINET DIMENSIONS

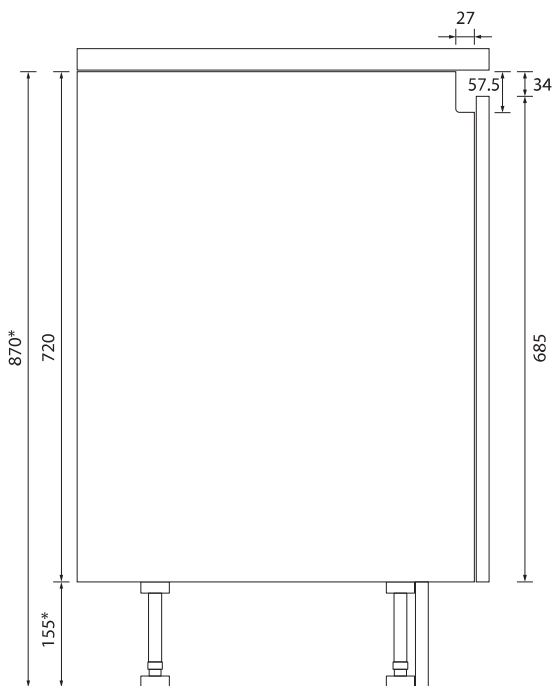

* nb. If installing an intergrated appliance in the kitchen please add a minimum of 5mm to allow for easy installation of appliance.

1. Top Profile (100TOP4100)
2. Internal Corner Joint - Top (100TOPINT90)
3. External Corner Joint - Top (100TOPEXT90)
4. Quick Fix Bracket (100QFIX)
5. End Cap - Top (100TOPENDCAP)

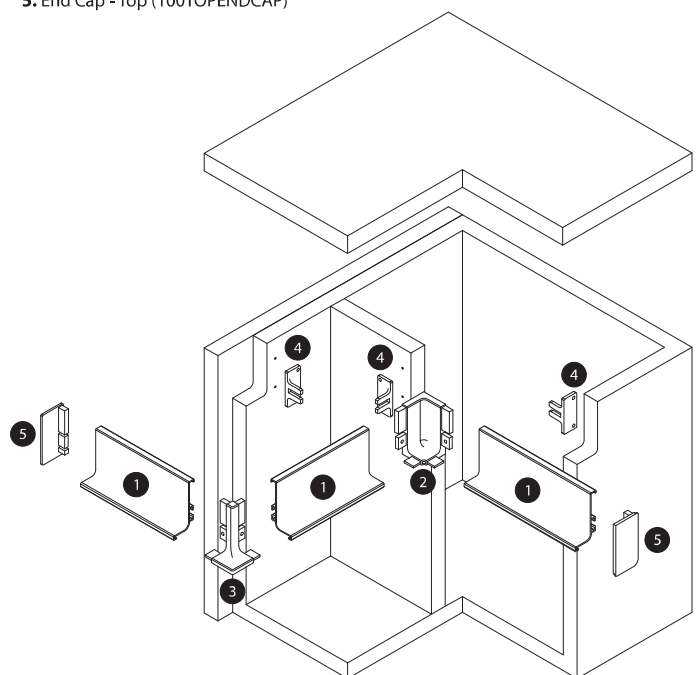

Mid Profile

Code

100MID4100

Finish / Material

Aluminium

Dimensions

4100 x 73 x 26mm

Accessories available

Quick Fix Brackets (100QFIX)

End Cap - Mid (100MIDENDCAP)

Internal Corner Joint - Mid (100MIDPINT90)

External Corner Joint - Mid (100MIDEXT90)



- Used for mid and bottom drawers.
- Can be cut to size using a circular chop saw.
- Secured to cabinets with Quick Fix Brackets.
- Profiles can be finished off with End Caps before fitting.
- Mid profiles can be linked at corners using Internal and External Corner Joints.

DIMENSIONS

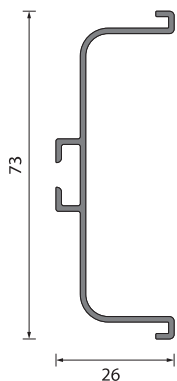

FITTED DETAIL

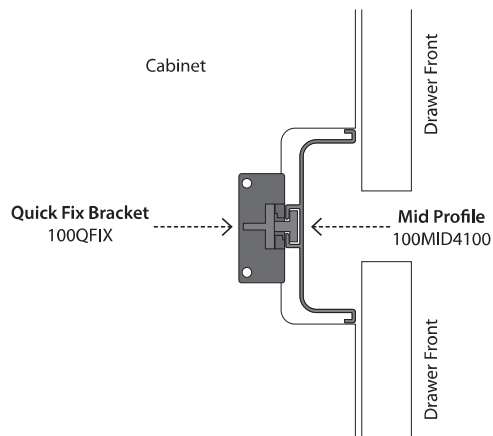

CABINET ROUTING

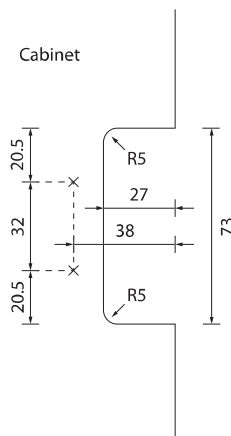

CABINET DIMENSIONS

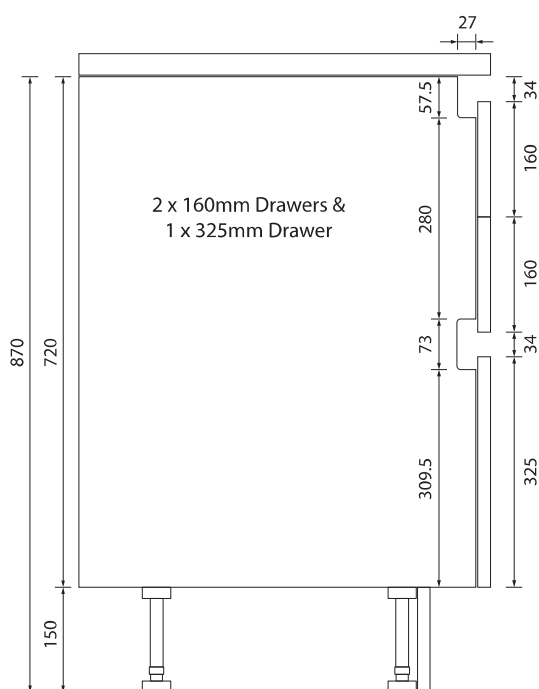
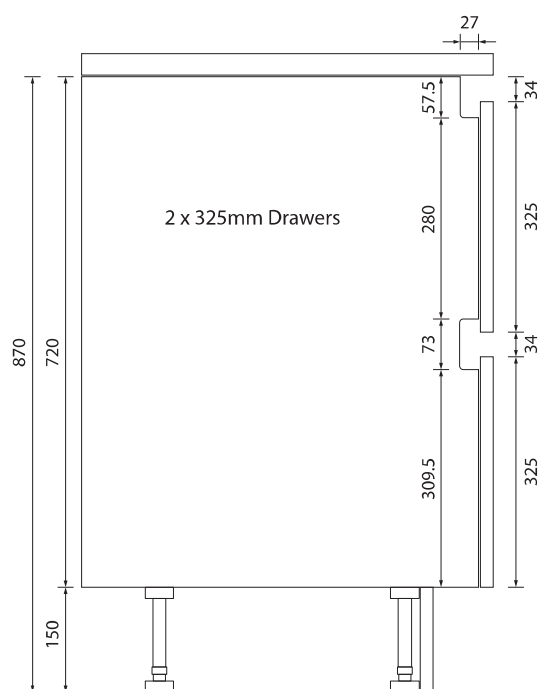

Integrating under counter appliances

Integrated Dishwasher

- The Top Profile (100TOP4200) can be used to run above integrated appliance.
- It's recommended to set integrated dishwasher height at 815mm to fit under the rail.
- Metal brackets (supplied with dishwasher) should be fixed to the outer face of adjacent cabinets. Please note, an additional bracing baton may be required to the rear of the machine to help reduce movement.
- If drawers are situated next to an integrated appliance, we recommend using end caps to cover any gaps.

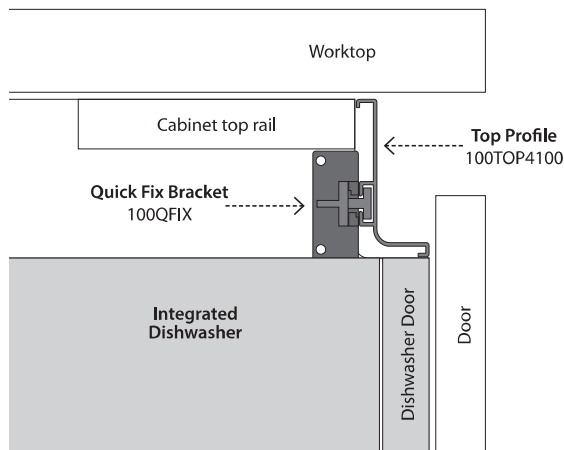

IMPORTANT INFORMATION

We recommend extending the cabinet legs to at minimum height of 155mm to ensure the integrated dishwasher will fit underneath the top rail.

It is also recommended to set integrated dishwasher height at 815mm.



Undermounted Oven

- The Top Profile (100TOP4200) can't be used in conjunction with an under mounted oven. Profiles must stop on each side of the appliance and can be finished with end caps.
- If using a freestanding cooker, end panels will need to be fitted either side of the appliance and the profile finished against the panel.

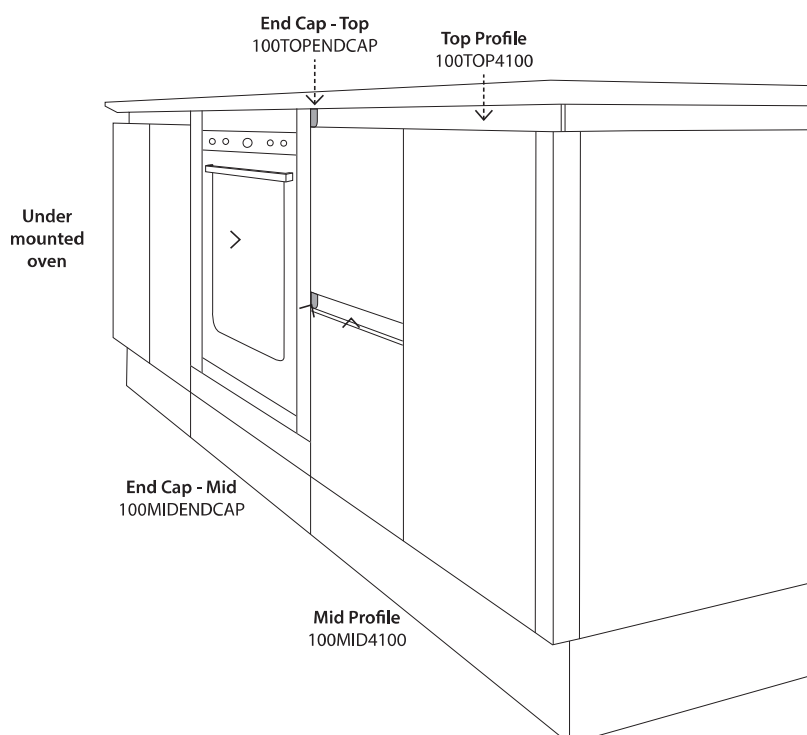

Vertical Profile - Intermediate

Code

100VERTMID4200

Finish / Material

Aluminium

Dimensions

4100 x 71.6 x 41mm

Accessories available

100VERTSPACER



- Used on tall units when two opening doors meet.
- Secured to cabinet gables with 25mm cabinet screws.
- Can be cut to size using a circular chop saw.
- A 35mm spacer (not supplied) is required at the back between the two cabinets to maintain the void created by the profile trim.
- The front of the cabinet gables need to be set back by 20mm for the trim to overlap behind the doors.

DIMENSIONS

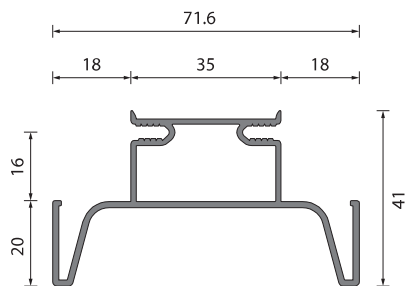

FITTED DETAIL

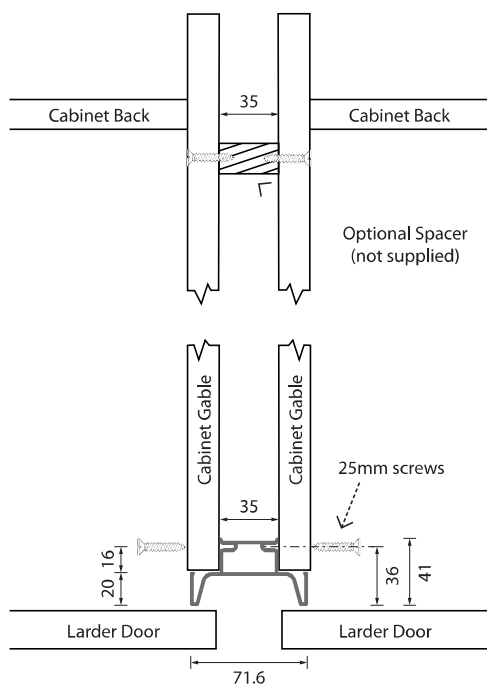

APPLICATION BETWEEN TWO DOORS

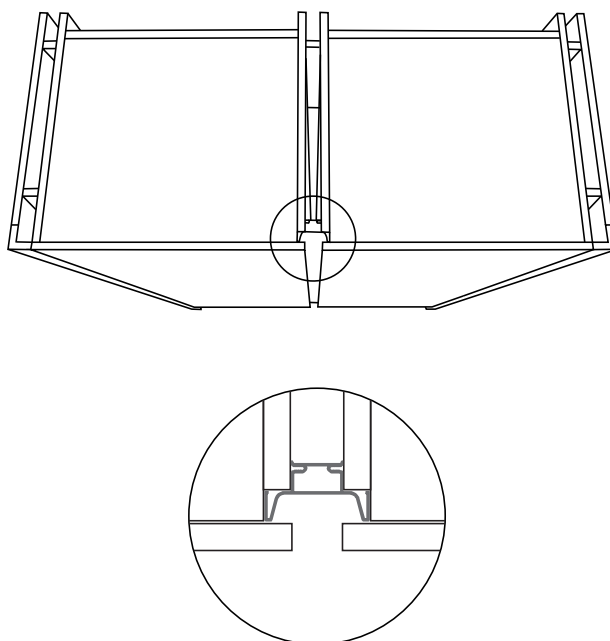

Vertical Profile - Lateral

<p>Code 100VERTEND4200</p> <p>Finish / Material Aluminium</p> <p>Dimensions 4100 x 53.3 x 41mm</p> <p>Accessories available 100VERTSPACER</p>	 <ul style="list-style-type: none"> • Used on tall units when you have an opening door on one side only, can also be used to end a run where an end post or end panel is fitted. • Secured to cabinet gable with 25mm cabinet screws. • Can be cut to size using a circular chop saw. • A 35mm spacer (not supplied) is required at the back between two cabinets or between a cabinet and end panel. • The front of the cabinet gable needs to be set back by 20mm for the trim to overlap behind the door. • To fix an end post or end panel to the profile you need to drill through the screw support channel and attach the end post from the inside of the cabinet with a 60mm screw.
---	--

DIMENSIONS

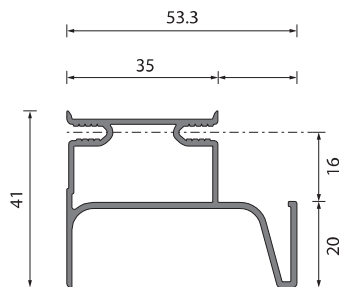

FITTED DETAIL

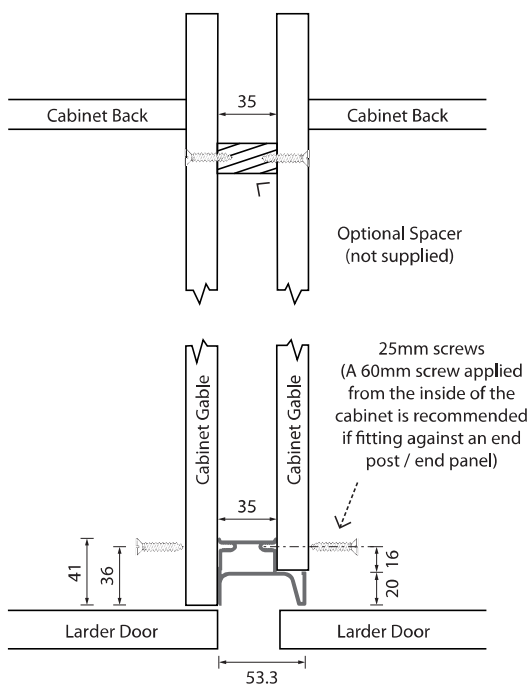

APPLICATION BETWEEN TWO DOORS

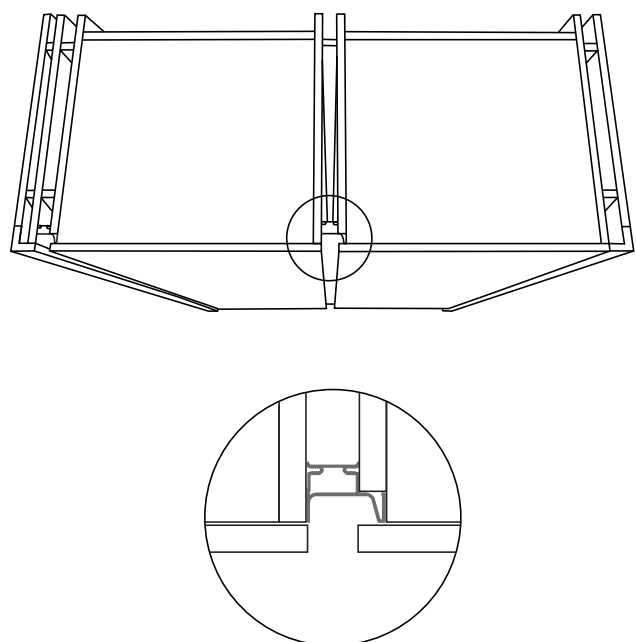

Spacer for Appliance

Code

100VERTSPACER

Finish / Material

Aluminium

Dimensions

580 x 19.6 x 20.8mm



- Used to conceal the space behind the front of an appliance when used in an appliance housing unit combined with vertical Vero profiles.
- Fixed into the cabinet gable with 3 screws (4 x 16mm).
- Works with both intermediate and lateral vertical profiles.
- The trim can be cut down to suit different sized appliances. If doing so, we recommend that a metal file is used to remove any sharp edges on the cut edge and that it is positioned out of sight.
- If the appliance requires a screw fixing into the cabinet, the spacer can be drilled into to accommodate the screws.
- When stacking appliances, we recommend leaving a 10mm gap to the top and bottom of both appliances.

DIMENSIONS

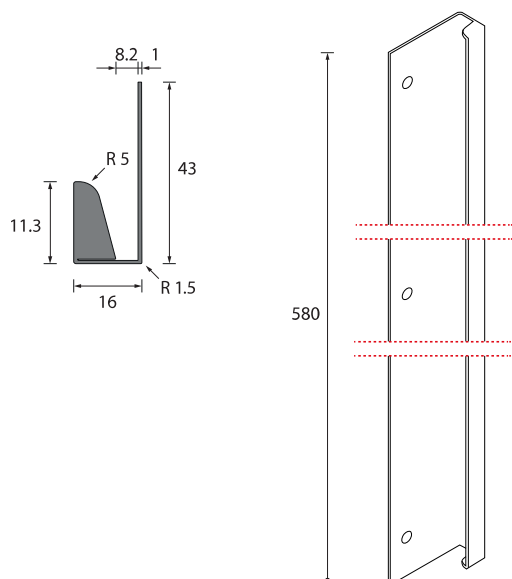

FITTED DETAIL

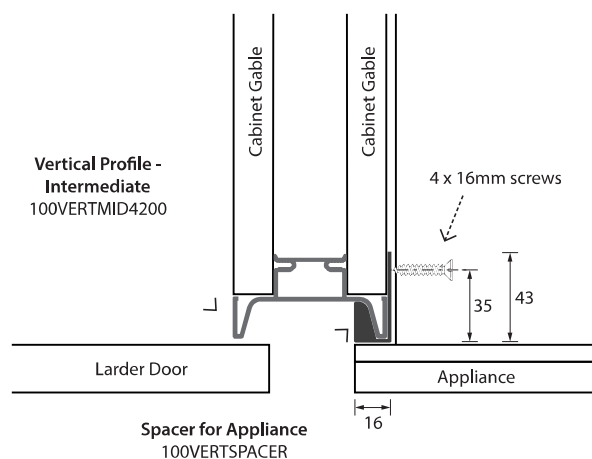

APPLIANCE INSTALLATION

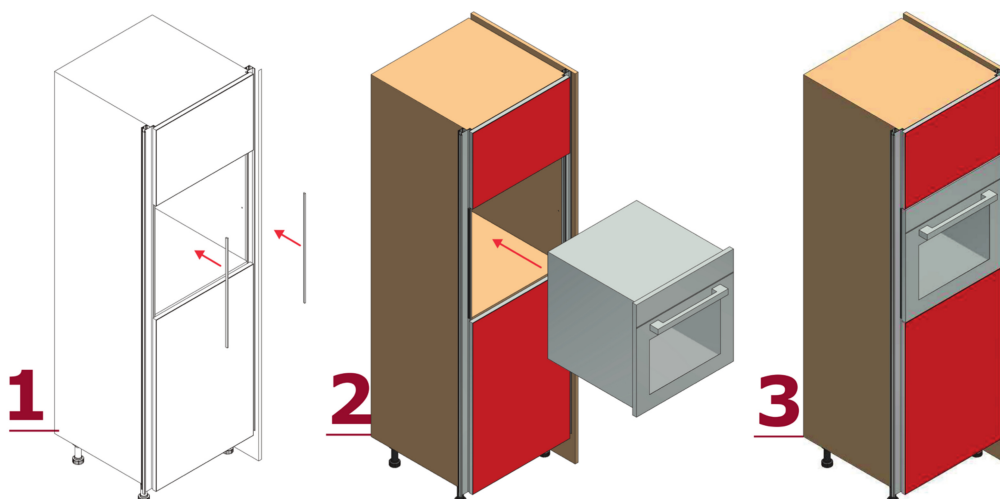

Wall Cabinet Profile

<p>Code 100WALL3900</p> <p>Finish / Material Aluminium</p> <p>Dimensions 3900 x 19.6 x 20mm</p> <p>Accessories available N/A</p>	 <ul style="list-style-type: none"> • Concealed rail used on wall units. • Can be cut to size using a circular chop saw. • The base panel on the wall cabinet must be set back with 20mm to accommodate the rail profile within the cabinet. • The base panel must also have a 8mm deep, 3mm high routed groove for the profile to slot into. • Clear silicone adhesive should be used to bind the rail with the panel.
--	---

DIMENSIONS

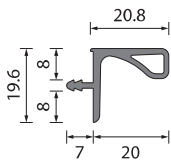

FITTED DETAIL

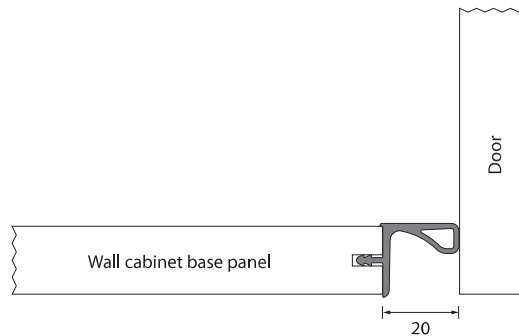

CABINET ROUTING

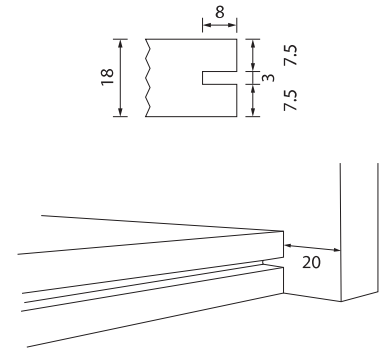

Quick Fix Brackets

Code
100QFIX

Finish / Material
Plastic

Dimensions
N/A

Accessories available
N/A

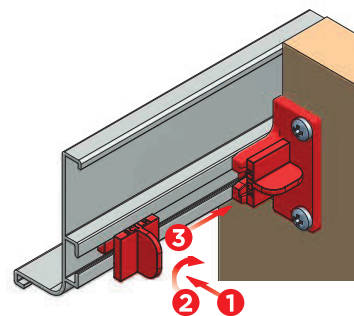
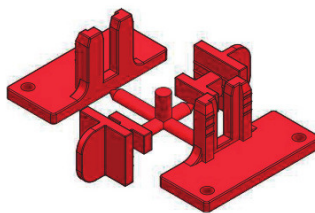

- Screw mounted brackets for top and mid profiles.
- Comes in pairs (min. order 25 pairs).

FITTING TOP AND MID PROFILES

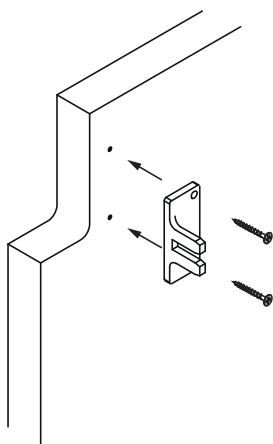

Step 1.
Attach quick fix brackets (100QFIX) to routed cabinet gables using screws.

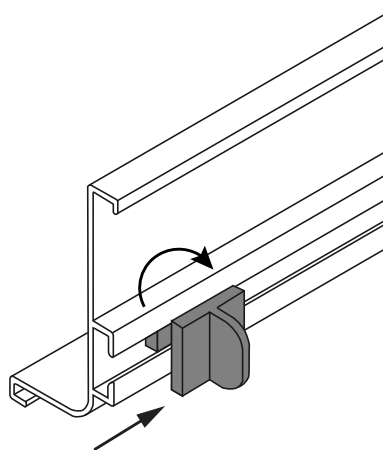

Step 2.
Slide the connectors into the back of the profile and turn 90 degrees.

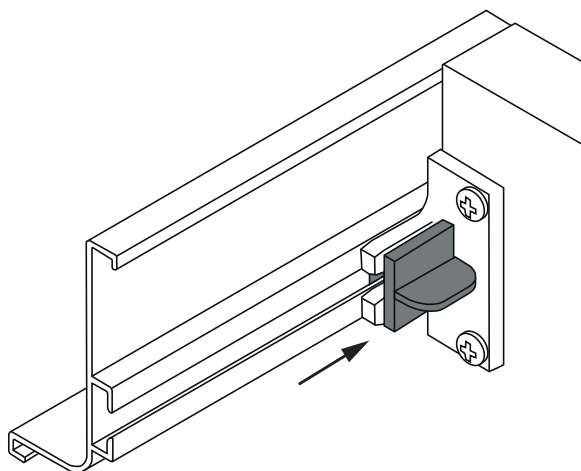

Step 3.
Apply profile to routed cabinet and push connectors into brackets to secure the profile to the cabinet.

Internal Corner Joint - Top

Code
100TOPINT90

Finish / Material
Aluminium

- Used to connect two top profiles at an internal corner, to be used together with an internal corner post.
- Secured to the top profile using two screws (supplied).

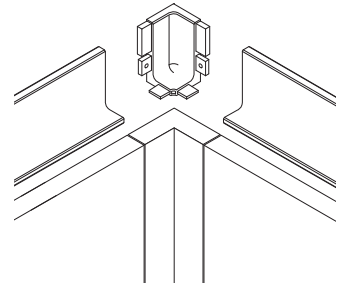
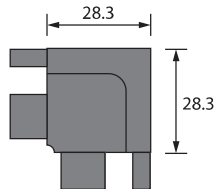
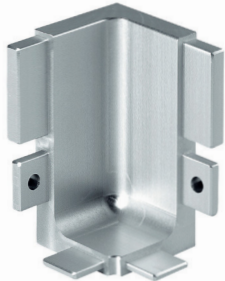

External Corner Joint - Top

Code
100TOPEXT90

Finish / Material
Aluminium

- Used to connect two top profiles running around an external corner or an island unit, to be used together with an external corner post.
- Secured to the top profile using two screws (supplied).

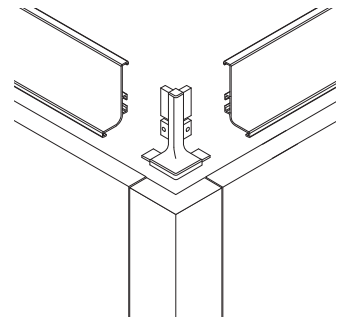
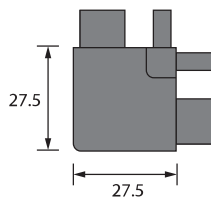

Top Joint

Code
100TOPJOINT

Finish / Material
Aluminium

- Used to join together lengths of top profiles.
- Held in place with 4 grub screws (supplied).
(Grub screw secured with Allen key)
- When using top joints a 8mm spacing must be taken into account when cutting down the profiles that are being joined together.

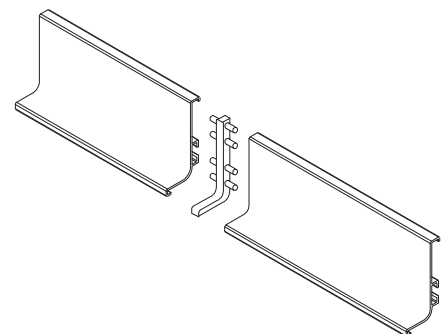
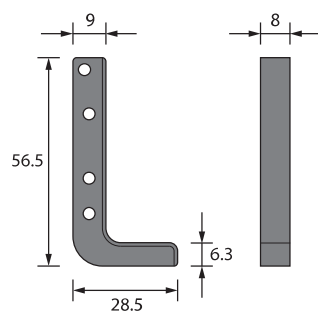

Internal Corner Joint - Mid

Code
100MIDINT90

Finish / Material
Aluminium

- Used to connect two mid profiles at an internal corner, to be used together with internal corner posts.
- Secured to the mid profile using two screws (supplied).

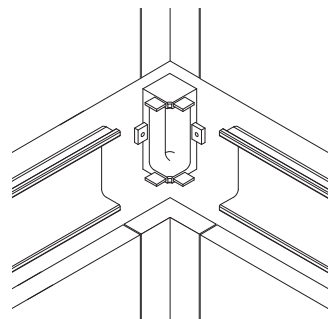
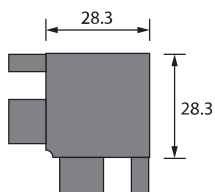

External Corner Joint - Mid

Code
100MIDEXT90

Finish / Material
Aluminium

- Used to connect two mid profiles running around an external corner or an island unit, to be used together with external corner posts.
- Secured to the mid profile using two screws (supplied).

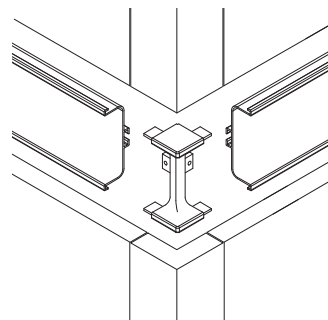
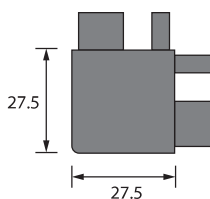

End Caps - Top

Code
100TOPENDCAP

Finish / Material
Aluminium

- Used at the end of a top profile for example against a wall, end panel or next to appliances such as under mounted oven.
- Secured to the top profile using a grub screw (supplied).
(Grub screw secured with Allen key)
- When using end caps, a 2mm spacing must be taken into account when cutting down the trim.

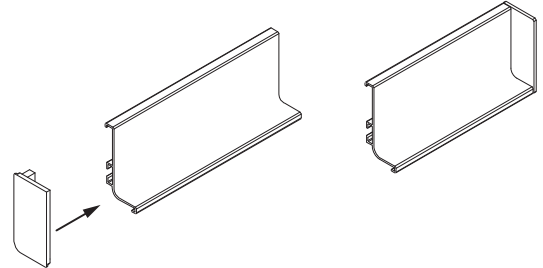
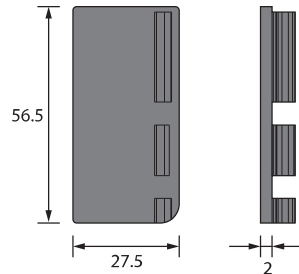

End Caps - Mid

Code
100MIDENDCAP

Finish / Material
Aluminium

- Used at the end of a mid profile for example against a wall, end panel or next to appliances such as under mounted oven.
- Secured to the mid profile using a grub screw (supplied).
(Grub screw secured with Allen key)
- When using end caps, a 2mm spacing must be taken into account when cutting down the trim.

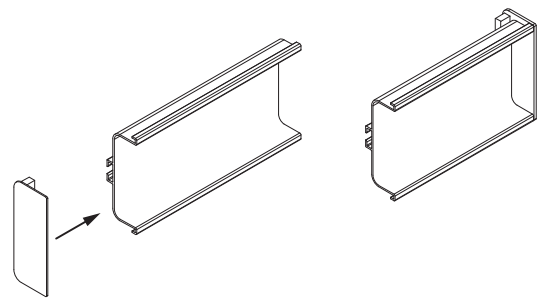
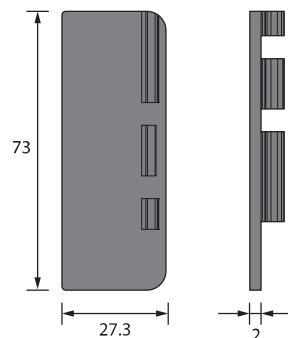

Suggested door & drawer combinations for Vero handleless rail system

685	160	325	160		
			160		
	490	325	325		
	150mm Plinth				110
147	446	596	496	496	596
296	496		596	596	Built
315	546		796	796	Under
346	596		896	896	Oven
396			996	996	

1965	1245	715	980	450	490	645	490
	715	1245	980	600	900	600	380
				450	570	715	490
150mm Plinth							

Full Length Doors	Fridge / Freezer	Fridge / Freezer	Fridge / Freezer	Microwave Oven / Coffee Maker & Single Oven	Double Oven	Single Oven	Microwave Oven & Single Oven
296							
396							
496							
596							

Diagram illustrating the dimensions and components of a 150mm Plinth. The plinth is divided into sections with the following dimensions and components:

- Left Section:** A vertical section with a height of 1245.
- Second Section:** A vertical section with a height of 900, containing a "filler" component.
- Third Section:** A vertical section with a height of 600, containing a "filler" component, and a base section with a height of 570.
- Fourth Section:** A vertical section with a height of 460, containing a "filler" component, and a base section with a height of 715.
- Fifth Section:** A vertical section with a height of 600, containing a "filler" component, and a base section with a height of 570.
- Sixth Section:** A vertical section with a height of 600, containing a "filler" component, and a base section with a height of 160 and 325.
- Seventh Section:** A vertical section with a height of 460, containing a "filler" component, and a base section with a height of 325.
- Eighth Section:** A vertical section with a height of 460, containing a "filler" component, and a base section with a height of 685.

The total width of the plinth is 150mm.

Full Length Doors	Double Oven	Single Oven	Microwave / Coffee Maker	Single Oven	Single Oven	Microwave / Coffee Maker	Microwave / Coffee Maker
296							
396							
446							
496							
596							

895	1245	175	490	570	490	715		
			460	380	900		600	
			600	600		filler		110
	1245		895	980		110	570	175
					450		570	
150mm Plinth								

Fridge / Freezer	Fridge / Freezer	Fridge / Freezer	Microwave Oven / Coffee Maker & Single Oven	Microwave Oven / Coffee Maker & Single Oven	Double Oven	Single Oven
------------------	------------------	------------------	---	---	-------------	-------------